

GL11TB VE10
220-240V 50Hz ~1

COMPRESSOR

Displacement (cm ³)	9.95
Diameter (mm)	25.4
Stroke (mm)	19.62
Net Weight (Kg)	11
Oil type	ISO VG 22 ESTER
Oil charge (cm ³)	400

MOTOR

Approximate Power (CV)	1/3
Voltage/Frequency (V/Hz)	220V 50Hz
Voltage range (V)	198-254
Code	-
Type	CSIR
Phase number	1 PH
Locked rotor current (A)	12.5
Main W. resist. at 25°C (Ω)	8.13
Start W. resist. at 25°C (Ω)	23.17

APPLICATION

Application	High/Mid. back pressure
Refrigerant	R134a
Evaporating (°C)	-25 to 10
Expansion	Capillar/Valve
Comp. cooling	Fan cooled
Max. ambient temp. (°C)	43

NOMINAL PERFORMANCE

	CYCLE C	CYCLE D
Cooling capacity (kcal/h)	703	840
Input power (W)	422	438
EER (kcal/Wh)	1.66	1.91
COP (W/W)	1.93	2.23
Current (A)	2.53	2.59

TEST CONDITIONS

	CYCLE C	CYCLE D
Evaporating temp. (°C)	5.0	7.2
Condensing temp. (°C)	55.0	55.0
Liq.t. entering expan. (°C)	55.0	46.0
Ambient t. and return (°C)	32.0	35.0
Tens/Freq (V/Hz)	220V 50Hz	220V 50Hz

ELECTRICAL COMPONENTS

Relay	2014 138.	
Pick-Up	6,10 (A)	
Drop-Out	5,20 (A)	
Protector	MST26AMK	T0181
Current (A)	11.1	11.1
Time check (seg)	7.5-14	7.5-14
Disc temp. (Open/Close) (C)	105.0 / 61.0	105.0 / 61.0
Starting capacitor (μF/V)/F/V)	47- 56 / 330	

DIMENSIONS AND ELECTRICAL DIAGRAM

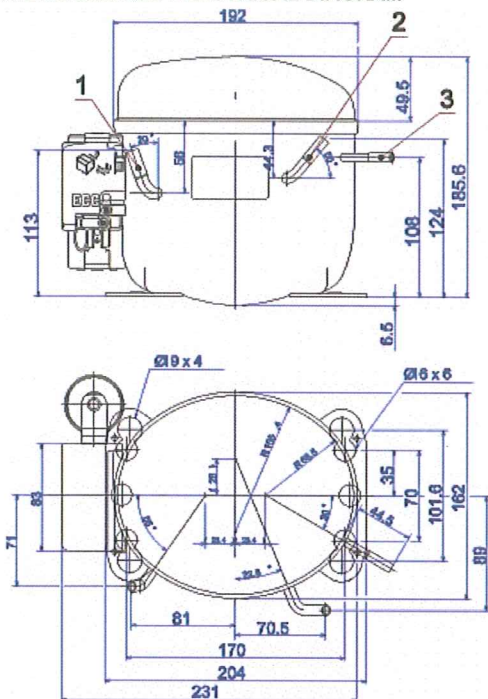

DESIGNATION

- 1 Suction/Service
- 2 Service/Suction
- 3 Discharge

INTERNAL DIAM. (MM)

- 6,5
- 6,5
- 4,9

CSIR

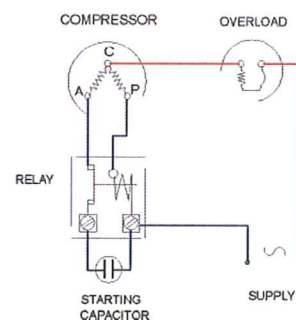

TEST CONDITIONS

Voltage/frequency	220V 50Hz
Ambient t. and return	35 °C
Liq.t. entering expan.	Subcooling 9 K

MASS FLOW

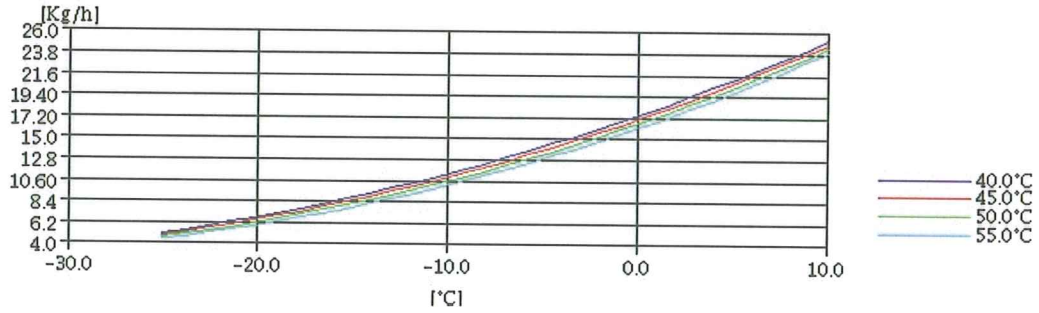

INTENSITY

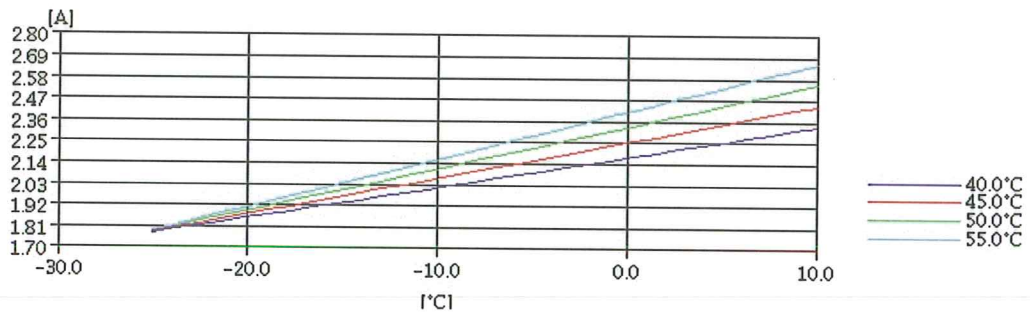

CONSUMPTION

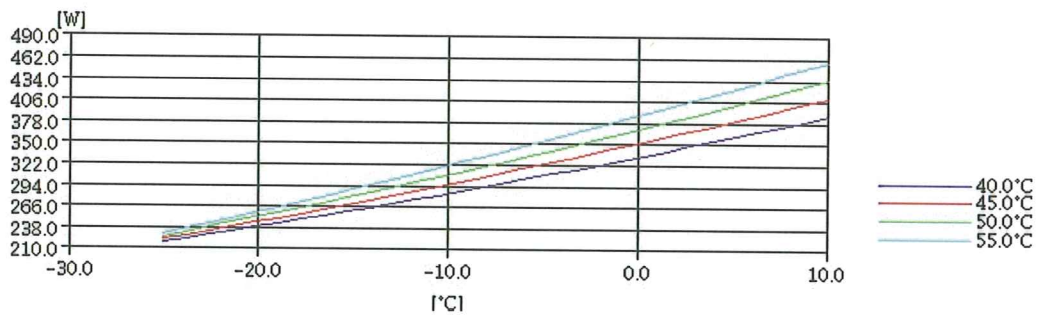

COOLING CAPACITY

